

- Telaio predisposto per l'installazione sia su parete da intonaco che da cartongesso.
- Sono disponibili due modelli, che possono essere indifferentemente "tirare sinistra/spingere destra", "tirare destra/spingere sinistra".
- La sezione **tubolare\*** garantisce un'alta resistenza alla deformazione.
- La presenza di zigrinature ottimizza il fissaggio delle lastre e dello stucco o la presa dell'intonaco.
- **Realizzato in alluminio anodizzato**, assicura un'elevata adesione della vernice.
- Le sedi delle cerniere e dell'incontro sono protette da appositi tappi.
- La guarnizione è applicabile direttamente su tutti i 3 lati del telaio.

- Frame suitable for solid and plasterboard walls.
- There are two versions available, which can be equally "pull to the left/ push to the right" or "pull to the right/push to the left".
- The **tubular section\*** guarantees a high resistance to deformation.
- The presence of knurls optimise the fixing of plasterboards and the posing of plaster.
- **Made of anodized aluminium**, it ensures a high adherence of the paint.
- Special caps protect the hinge seats.
- The weatherstrips are applicable directly on all three sides of the frame.

**1** Distanziali in OSB che permettono la stuccatura o l'intonacatura in un'unica soluzione durante la posa.  
OSB spacers that allow grouting or plastering in a single solution during the installation.

**2** Ancoraggi per struttura metallica per cartongesso.  
Anchoring elements for metal structure for plasterboard.

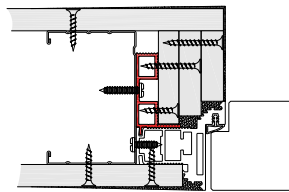

**3** Zanche d'ancoraggio per muratura.  
Anchoring brackets for solid walls.

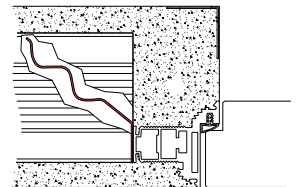

**4** Profilo zigrinato per un miglior fissaggio delle lastre in cartongesso, dello stucco o dell'intonaco.  
Knurled profile for better fixing of plasterboard sheets or plaster.

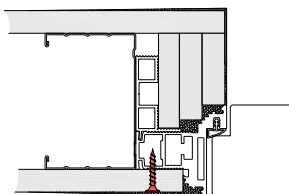

**5** Cerniere premontate regolabili sui tre assi con portata 40 o 60 Kg con finitura a scelta.  
Adjustable pre-assembled hinges on 3 axes with 40 or 60 Kg capacity with choice of finishing.

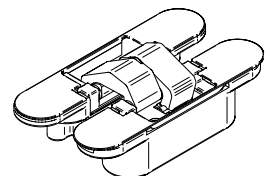

**6** Assemblaggio del telaio con squadrette a pulsante.  
Frame assembly with push button brackets.

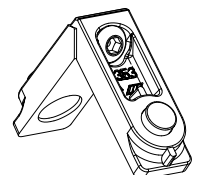

- + Sedi guarnizioni sui 3 lati del telaio  
Weatherstrip seat on 3 sides of the frame
- + Telaio anodizzato  
Anodized frame
- + Cerniere protette  
Protected hinges

CARATTERISTICHE TECNICHE DELLA PORTA - TECHNICAL FEATURES OF THE DOOR

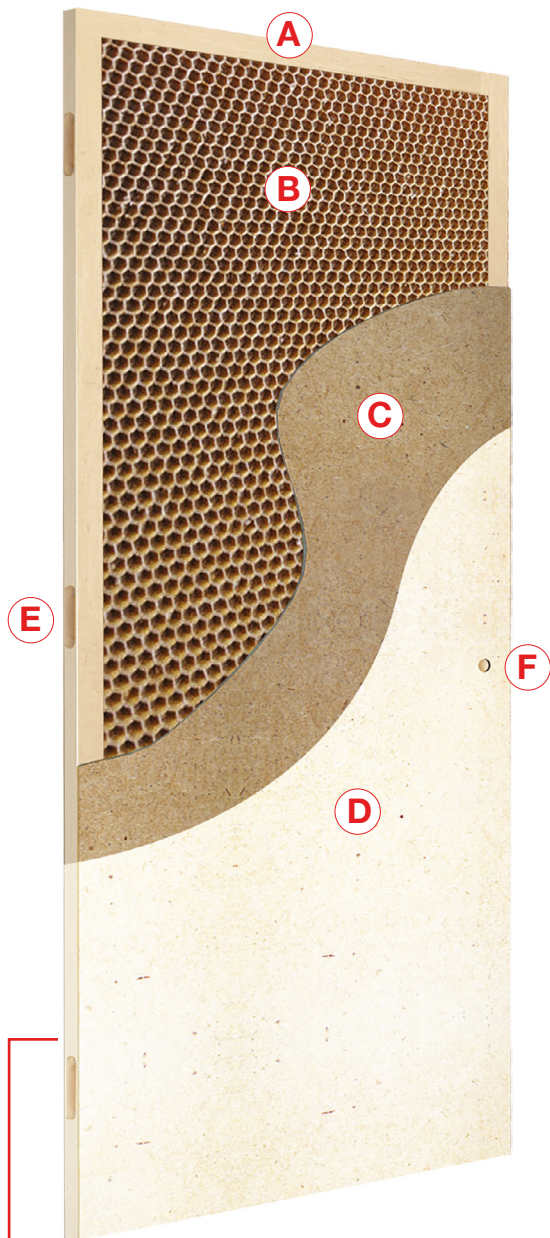

**SPESORE MAGGIORATO 50 MM**  
**INCREASED THICKNESS 50 MM**

- Spessore del pannello porta 50 mm.
- Rivestita con Primer, assicura un'elevata adesione della pittura.
- Intelaiatura in abete "Finger Joint", assicura maggiore compattezza, stabilità e resistenza meccanica.
- Per altezze a partire da 2400 mm è dotato di tiranti per garantire la planarità.
- Viene fornito con predisposizione per serratura magnetica e foro maniglia, con o senza chiave, chiusura con nottolino a richiesta.
- Predisposizione per 3 cerniere fino ad altezza 2350 mm.
- Predisposizione per 4 cerniere per altezze superiori a 2350 mm.
- La sua particolare forma consente l'installazione su sistemi sia a spingere che a tirare.

- Door panel 50 mm thick.
- Covered with Primer, which ensures a high adherence of the paint.
- "Finger joint" fir framework, which guarantees higher compactness, stability and mechanical resistance.
- Systems higher than 2400 mm include tie-rods, in order to ensure its alignment.
- Supplied with magnetic lock predisposition and hole for handle, with or without key, closing with thumbturn on demand.
- Set up for 3 hinges till heights of 2350 mm.
- Set up for 4 hinges for heights more than 2350 mm.
- Its particular shape allows the installation on systems both to push or to pull.

STRUTTURA COMPOSTA DA / STRUCTURE COMPOSED BY:

- A** Intelaiatura in abete "Finger Joint"  
Fir frame "Finger Joint"
- B** Interno a nido d'ape  
Honeycomb core
- C** Rivestimento in MDF  
MDF coating
- D** Pretrattamento con Primer per una migliore presa della pittura  
Pre-treatment with Primer for a better grip of painting
- E** Sede per cerniera  
Seat for hinge
- F** Sede per serratura  
Seat for lock

- + **Pannello con primer**  
Panel with primer
- + **Tiranti da H 2400**  
Tie-rods from H 2400
- + **3 Cerniere minimo**  
Minimum 3 hinges

## COMPONENTI PRODOTTO

### PRODUCT COMPONENTS

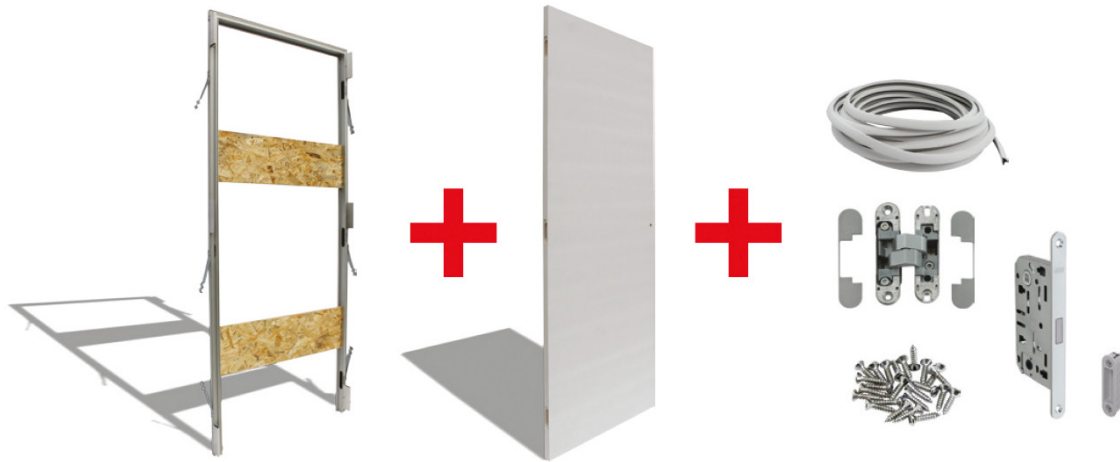

- Telaio Battente Fifty.
- Pannello porta 50 mm con primer.
- Ancoraggi cartongesso e intonaco.
- 3 Cerniere 40 kg cromo satinato + 3 copricerniere (4 cerniere + 4 copricerniere per altezze maggiori di 2350 mm).
- 1 Serratura magnetica con foro chiave.
- 1 Chiave.
- 1 Incontro.
- Guarnizione laterale e superiore (7 metri).

- Battente Fifty frame.
- 50 mm door panel with primer.
- Plasterboard and plaster anchors.
- 3 hinges 40 kg satin chrome + 3 covers (4 hinges + 4 covers for height above 2350 mm).
- 1 Magnetic lock with key hole.
- 1 Key.
- 1 Linking element.
- Lateral and upper weatherstrips (7 meters).

TIRARE A SINISTRA, SPINGERE A DESTRA - PULL LEFT, PUSH RIGHT

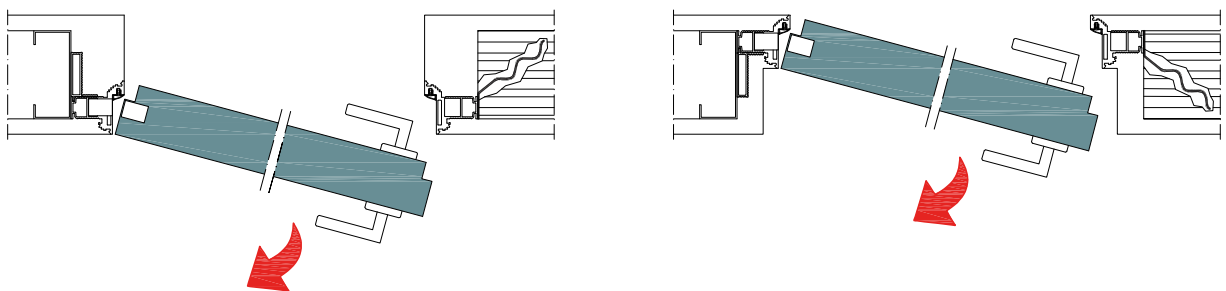

TIRARE A DESTRA, SPINGERE A SINISTRA - PULL RIGHT, PUSH LEFT

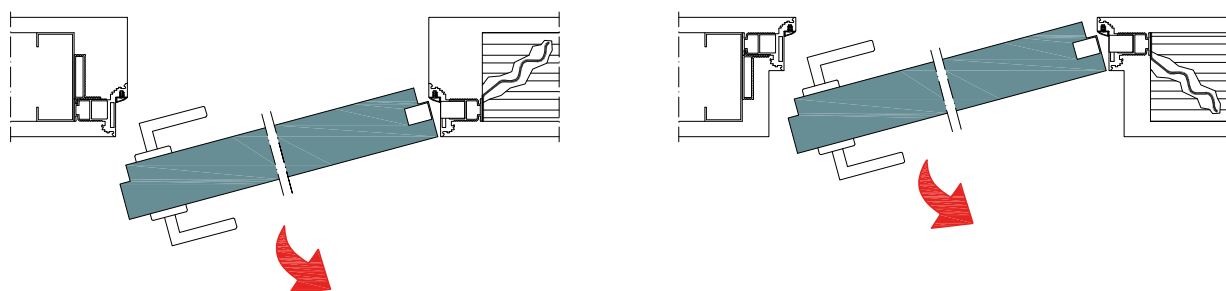

TIRARE A SINISTRA, SPINGERE A DESTRA - PULL LEFT, PUSH RIGHT

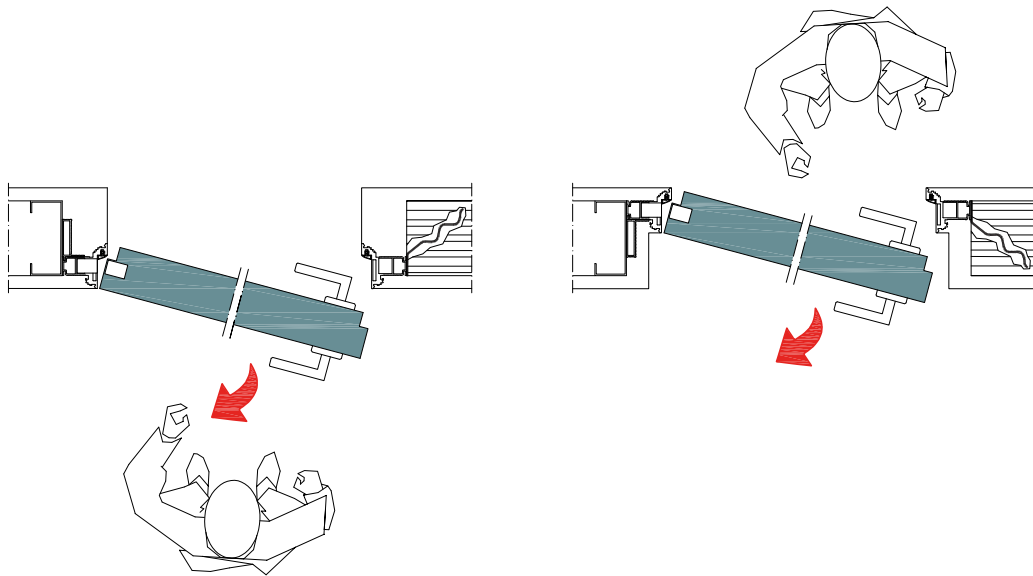

TIRARE A DESTRA, SPINGERE A SINISTRA - PULL RIGHT, PUSH LEFT

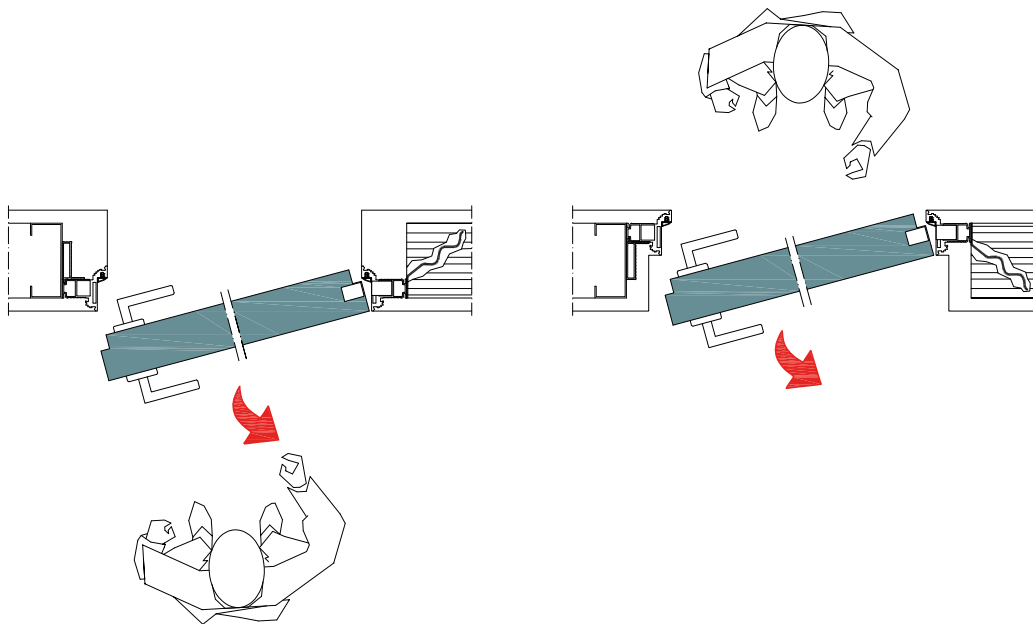

CON TRAVERSO  
WITH UPPER BEAM

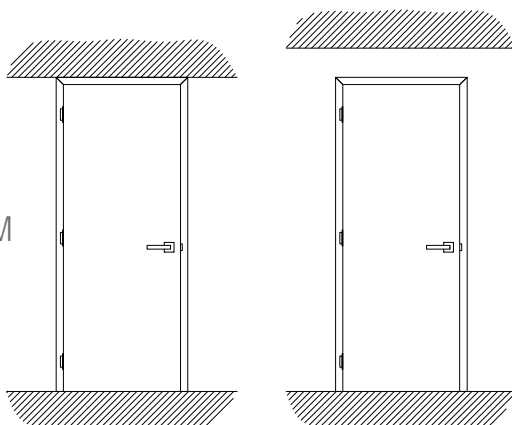

SENZA TRAVERSO  
WITHOUT UPPER BEAM

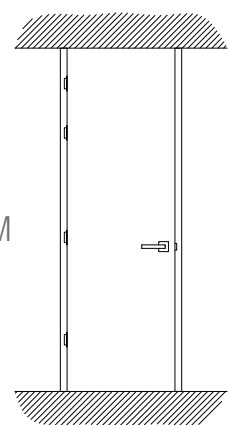

TIRARE A SINISTRA, SPINGERE A DESTRA - PULL LEFT, PUSH RIGHT

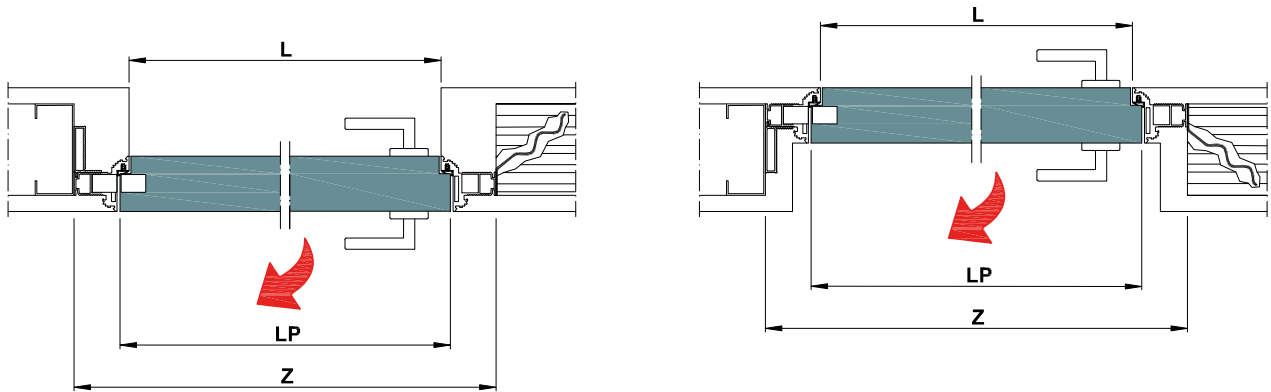

TIRARE A DESTRA, SPINGERE A SINISTRA - PULL RIGHT, PUSH LEFT

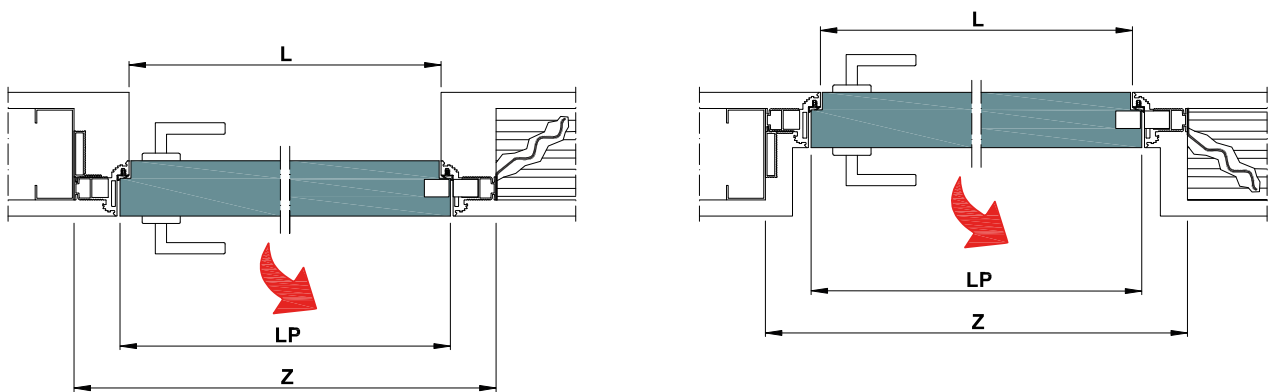

A TIRARE  
 CON TRAVERSO

PULL WITH  
 UPPER BEAM

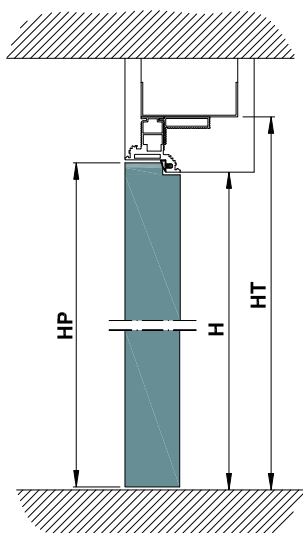

SENZA  
 TRAVERSO

WITHOUT  
 UPPER BEAM

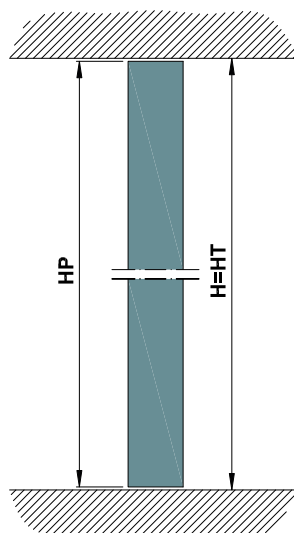

A SPINGERE  
 CON TRAVERSO

PUSH WITH  
 UPPER BEAM

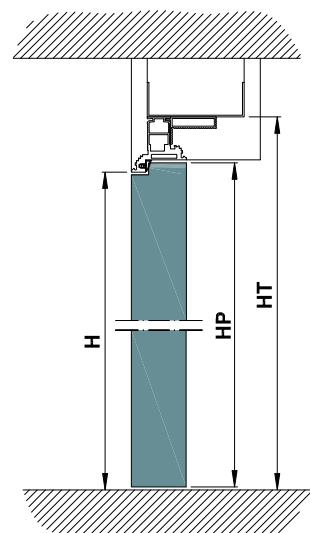

POSA A TIRARE - INSTALLATION TO PULL

POSA A SPINGERE - INSTALLATION TO PUSH

PROFILO PER PARETI DA **INTONACO** - PROFILE FOR **SOLID WALLS**

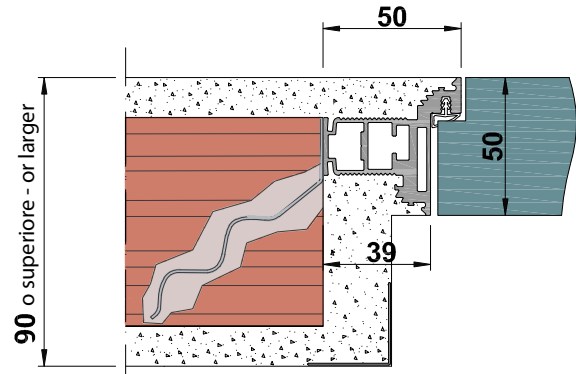
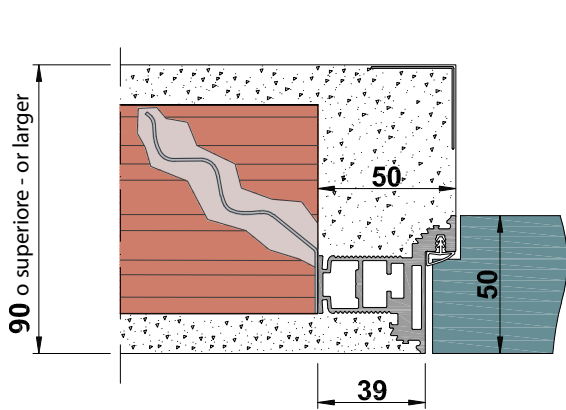

PROFILO PER PARETI IN **CARTONGESSO SINGOLA LASTRA**, PARETE FINITA 100/125 mm  
PROFILE FOR **PLASTERBOARD WALLS SINGLE SHEET**, FINISHED WALL 100/125 mm

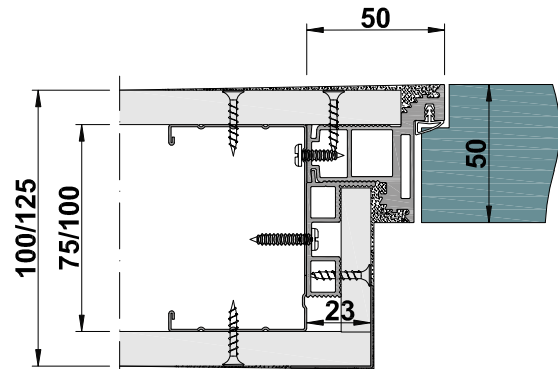
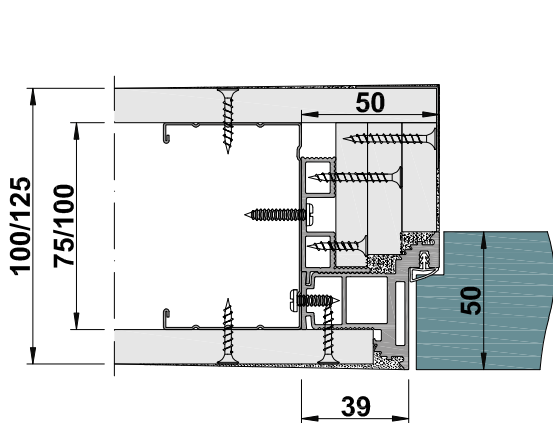

PROFILO PER PARETI IN **CARTONGESSO DOPPIA LASTRA**, PARETE FINITA 100/125/150 mm  
PROFILE FOR **PLASTERBOARD WALLS DOUBLE SHEET**, FINISHED WALL 100/125/150 mm

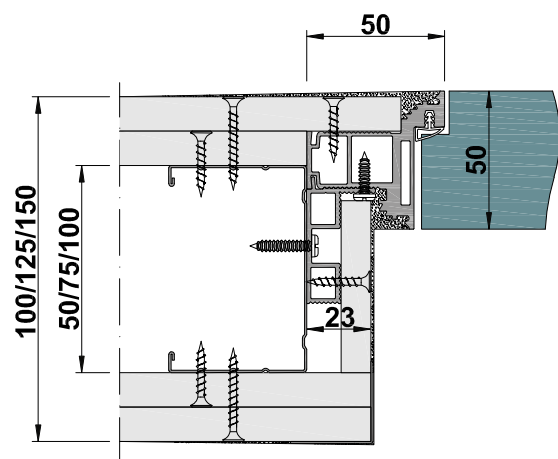
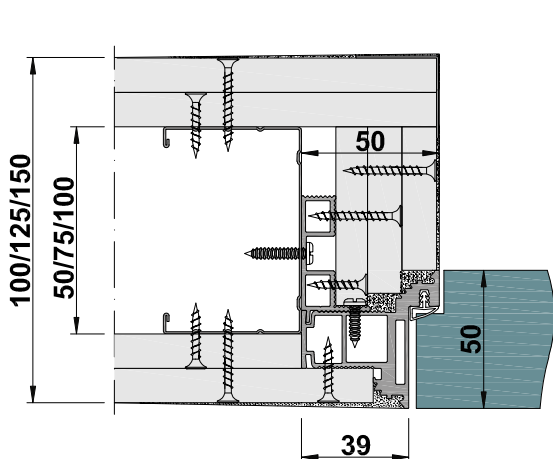





**COMPONENTI PRODOTTO: telaio in alluminio anodizzato, pannello porta e accessori**  
PRODUCT COMPONENTS: aluminium anodized frame, door panel and accessories

DISPONIBILE CON O SENZA TRAVERSO - AVAILABLE WITH OR WITHOUT UPPER BEAM

DIMENSIONI STANDARD - STANDARD DIMENSIONS

| LUCE DI PASSAGGIO<br>DOORWAY | MISURE DI INGOMBRO CON TRAVERSO<br>OVERALL DIMENSIONS WITH UPPER BEAM | MISURE DI INGOMBRO SENZA TRAVERSO<br>OVERALL DIMENSIONS WITHOUT UPPER BEAM |
|------------------------------|---|--|
| L x H                        | Z x HT  | Z x HT   |
| 600 x 2000/2035/2100/2400    | 700 x 2050/2085/2150/2450   | 700 x 2000/2035/2100/2400  |
| 700 x 2000/2035/2100/2400    | 800 x 2050/2085/2150/2450   | 800 x 2000/2035/2100/2400  |
| 800 x 2000/2035/2100/2400    | 900 x 2050/2085/2150/2450   | 900 x 2000/2035/2100/2400  |
| 900 x 2000/2035/2100/2400    | 1000 x 2050/2085/2150/2450  | 1000 x 2000/2035/2100/2400   |
| 1000 x 2000/2035/2100/2400   | 1100 x 2050/2085/2150/2450  | 1100 x 2000/2035/2100/2400   |

| PANNELLO PORTA (LEGNO)<br>DOOR PANEL (WOOD) |   |  |
|---|---|--|
|   | MISURE DI INGOMBRO CON TRAVERSO<br>OVERALL DIMENSIONS WITH UPPER BEAM | MISURE DI INGOMBRO SENZA TRAVERSO<br>OVERALL DIMENSIONS WITHOUT UPPER BEAM |
| LP  | HP  | HP   |
| 616   | 2004/2039/2104/2404   | 1990/2025/2090/2390  |
| 716   | 2004/2039/2104/2404   | 1990/2025/2090/2390  |
| 816   | 2004/2039/2104/2404   | 1990/2025/2090/2390  |
| 916   | 2004/2039/2104/2404   | 1990/2025/2090/2390  |
| 1016  | 2004/2039/2104/2404   | 1990/2025/2090/2390  |

FUORI MISURA - OVERSIZE

| LUCE DI PASSAGGIO<br>DOORWAY    | MISURE DI INGOMBRO CON TRAVERSO<br>OVERALL DIMENSIONS WITH UPPER BEAM | MISURE DI INGOMBRO SENZA TRAVERSO<br>OVERALL DIMENSIONS WITHOUT UPPER BEAM |
|---------------------------------|---|--|
| L x H                           | Z x HT  | Z x HT   |
| 600 x 2200/2300/2500/2600/2700  | 700 x 2250/2350/2550/2650/2750  | 700 x 2200/2300/2500/2600/2700   |
| 700 x 2200/2300/2500/2600/2700  | 800 x 2250/2350/2550/2650/2750  | 800 x 2200/2300/2500/2600/2700   |
| 800 x 2200/2300/2500/2600/2700  | 900 x 2250/2350/2550/2650/2750  | 900 x 2200/2300/2500/2600/2700   |
| 900 x 2200/2300/2500/2600/2700  | 1000 x 2250/2350/2550/2650/2750                                       | 1000 x 2200/2300/2500/2600/2700  |
| 1000 x 2200/2300/2500/2600/2700 | 1100 x 2250/2350/2550/2650/2750                                       | 1100 x 2200/2300/2500/2600/2700  |

| PANNELLO PORTA (LEGNO)<br>DOOR PANEL (WOOD) |   |  |
|---|---|--|
|   | MISURE DI INGOMBRO CON TRAVERSO<br>OVERALL DIMENSIONS WITH UPPER BEAM | MISURE DI INGOMBRO SENZA TRAVERSO<br>OVERALL DIMENSIONS WITHOUT UPPER BEAM |
| LP  | HP  | HP   |
| 616   | 2204/2304/2504/2604/2704  | 2190/2290/2490/2590/2690   |
| 716   | 2204/2304/2504/2604/2704  | 2190/2290/2490/2590/2690   |
| 816   | 2204/2304/2504/2604/2704  | 2190/2290/2490/2590/2690   |
| 916   | 2204/2304/2504/2604/2704  | 2190/2290/2490/2590/2690   |
| 1016  | 2204/2304/2504/2604/2704  | 2190/2290/2490/2590/2690   |

**NOTE TECNICHE - TECHNICAL NOTES**

- Misure intermedie in larghezza (L) e in altezza (H) realizzate con intervalli ogni 50 mm.
- Per le misure non presenti nelle tabelle verificare fattibilità in azienda.
- Versioni senza traverso e oblique su richiesta.
- Intermediate sizes in width (L) and height (H) are available with a range of 50 mm.
- For sizes not mentioned in the schedules, please contact the company and ask for feasibility.
- Versions without upper beam and oblique on request.